

Bethany Baptist Church

Lindenwold, New Jersey

Design/Build: Myler Church Building Systems



MANUFACTURERS/SUPPLIERS

Exterior Walls — EIFS: Pleko;
Windows: Weathershield; **Doors:**
 CECO; **Wood Doors:** Oshkosh;
Finish Hardware: Yale/Stanley;
Steeple: Fiberglass Specialties.
Roof — **Shingles:** Bird; **Standing**
Seam: Star Building Systems.
Floors — **Carpet:** Patcraft;
VCT: Tarkett.

Interior Walls — **Gypsum Board &**
Acoustical Tile: United States Gypsum;
Ceiling Grid: Chicago Metallic;
Baptistry: Fiberglass Specialties.

Elevators — Schindler; **Wheelchair**
Lifts: National Wheel-O-Vator.

EXTENDED PRODUCT INFORMATION

Exterior Walls — EIFS: Pleko.
 See advertisement on page 27.

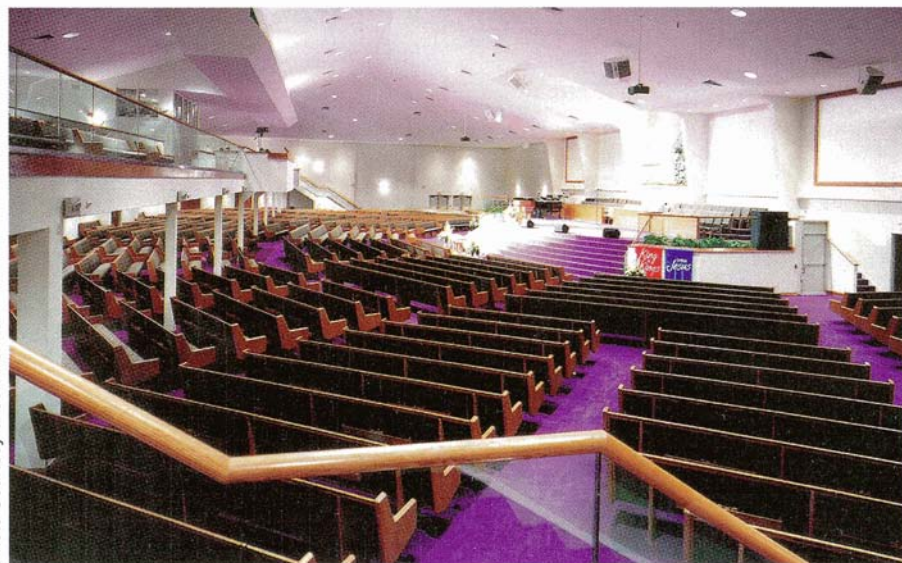
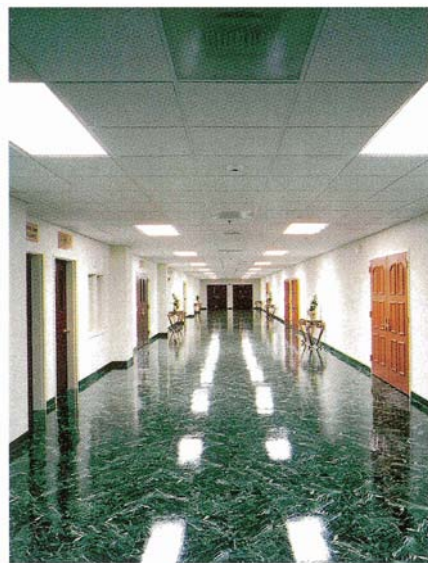

Photo Courtesy of Jon Denker



Early in 1995, the building committee of the Bethany Baptist Church, led by Bishop David Evans, met with representatives of Myler Church Building Systems for the purpose of planning a new facility to expand the ministry of this growing church south of Philadelphia. The Church had purchased approximately 32 acres of undeveloped land a few miles away from their current location and the design process began. Considered in the Master Plan was a 2,000-seat sanctuary, education wing for Sunday school, administrative space for a growing staff, a fellowship hall to seat 750 people, and day care facilities.

Like most projects, designing this new building was an evolutionary process. The design went through several revisions, always keeping in mind the Church's project

budget. One by one, all the design challenges were met, site and architectural plans were fine-tuned, and the project was submitted to the State and local building departments for permitting.

The final design for the worship area features seating for 1,985 people on the main level, and 504 seats in the balcony. Television broadcast capability was designed into the lighting/video/audio system as an important part of the Church's ministry needs. One outstanding feature of the sanctuary decor is a custom-built waterfall behind the baptistry. Easy flow from the parking area to the worship area is accomplished by the addition of two large port-a-cocheres. A spacious foyer offers communication from across the entire width of the assembly area.

Administrative space for ten offices was provided on the first floor of one wing, with education space for ten Sunday school classrooms provided on the second floor of that wing. The Fellowship Hall complex features a full commercial kitchen, restrooms with showers, and banquet style seating in the main area for 256 people under ten crystal chandeliers. This room was designed to serve a variety of roles, therefore a folding partition wall was installed for smaller functions.

On June 25, 2000, members of the Bethany Baptist Church, as well as many invited guests from the community, took part in a dedication service that celebrated all of the hard work and sacrifice that went into building the church.

DESIGN/BUILD

MYLER CHURCH BUILDING SYSTEMS

970 North Englewood Drive

Crawfordsville, IN 47933

www.myler.com

FILE UNDER

RELIGIOUS

Lindenwold, New Jersey

CONSTRUCTION TEAM

CONSTRUCTION MANAGER:

Myler Church Building Systems

970 N. Englewood Drive, Crawfordsville, IN 47933

STRUCTURAL ENGINEER: Morris & Associates, Inc.

853 Conner Street, Noblesville, IN 46060

ELECTRICAL/PLUMBING/MECHANICAL ENGINEER:

Myler Church Building Systems

970 N. Englewood Drive, Crawfordsville, IN 47933

CIVIL ENGINEER: J.T.S. Engineers and Land Surveyors, Inc.

19 Stratford Avenue, Stratford, NJ 08084

GENERAL DESCRIPTION

SITE: 32 acres.

NUMBER OF BUILDINGS: One.

BUILDING SIZES: First floor, 42,694; second floor, 9,778; total, 52,472 square feet.

BUILDING HEIGHT: Sanctuary eave, 26' to 42'; fellowship eave, 16' to 27'; administrative wing eave, 22' to 30'.

BASIC CONSTRUCTION TYPE: New/2B.

FOUNDATION: Concrete spread footings, concrete block stem walls, slab on grade.

EXTERIOR WALLS: EIFS, gypsum board, steel studs

ROOF: Pre-engineered, standing seam, shingles.

FLOORS: Carpet, VCT, quarry tile.

INTERIOR WALLS: Steel studs, drywall.

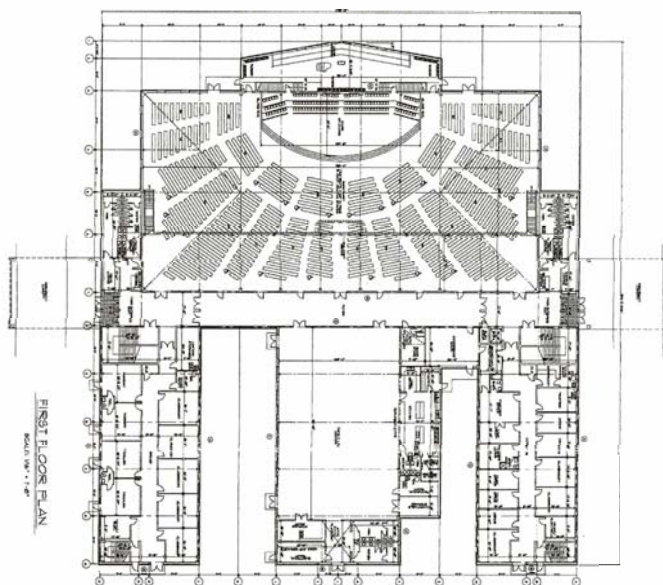

BETHANY BAPTIST CHURCH

Date Bid: May 1998 • Construction Period: June 1999 to July 2000 • Total Square Feet: 52,472

C.S.I. Divisions (1 through 16)	COST	% OF COST	SQ.FT. COST	SPECIFICATIONS
BIDDING REQUIREMENTS	203,347	3.09	3.88	Pre-bid information, instructions to bidders, information available to bidders, bid forms, supplements to bid forms, general conditions.
1. GENERAL REQUIREMENTS	498,413	7.56	9.50	1 Summary of work, allowances, measurement & payment, coordination, field engineering, project meetings, submittals, quality control, construction facilities & temporary controls, material & equipment, facility startup/commissioning, contract closeout, maintenance.
3. CONCRETE	385,489	5.85	7.35	3 Reinforcement, cast-in-place.
4. MASONRY	100,743	1.53	1.92	4 Unit.
5. METALS	1,690,302	25.65	32.21	5 —
6. WOOD & PLASTICS	248,365	3.77	4.73	6 Rough carpentry, finish carpentry, architectural woodwork.
7. THERMAL & MOIST. PROTECT	164,301	2.49	3.13	7 Waterproofing, insulation, EIFS, shingles & roof tiles, manufactured roofing & siding, flashing & sheet metal.
8. DOORS & WINDOWS	254,001	3.85	4.84	8 Metal doors & frames, wood & plastic doors, entrances & storefronts, wood & plastic windows, hardware, glazing.
9. FINISHES	1,010,728	15.34	19.26	9 Metal support systems, gypsum board, tile, acoustical treatment, resilient flooring, carpet, painting, wall coverings.
10. SPECIALTIES	159,422	2.42	3.04	10 Grilles & screens, wall & corner guards, operable partitions, toilet & bath accessories, wardrobe & closet.
11. EQUIPMENT	195,389	2.97	3.72	11 Food service.
12. FURNISHING	220,908	3.35	4.21	12 Multiple seating.
13. SPECIAL CONSTRUCTIONS	—	—	—	13 —
14. CONVEYING SYSTEMS	129,697	1.97	2.47	14 Elevators (2), lifts (1).
15. MECHANICAL	641,035	9.73	12.22	15 Plumbing, HVAC, testing, adjusting & balancing.
16. ELECTRICAL	687,392	10.43	13.10	16 Basic materials & methods, service & distribution, lighting, special systems, communications, controls.
TOTAL BUILDING COST	6,589,532	100%	\$125.58	
2. SITE WORK	1,126,711			2 Preparation, dewatering, earthwork, paving & surfacing, utility piping materials, water distribution, sewerage & drainage, ponds & reservoirs, improvements, landscaping. Included in Site Work.
LANDSCAPING & OFFSITE WORK	—			
TOTAL PROJECT COST	7,716,243			(Excluding architectural and engineering fees)

UPDATED ESTIMATE TO JUNE 2001: \$133.25 PER SQUARE FOOT